

SEIKAKU TECHNICAL GROUP LIMITED

客 戶	INVOTONE						
料 號	NF04393						
品 名	說明書-RS 英文						
規 格	DSX218SA INVOTONE_V1.0						
公司機種(客戶機種)成品料號	DSX218SA						
重 量 / 基 數							
材 質	NH00149 1:0.5						
紙張展開性質	<input checked="" type="checkbox"/> A3 <input type="checkbox"/> A4 <input type="checkbox"/> A5 <input type="checkbox"/> 其它					紙張展開數量	2pcs
核 准		審 核		校 稿		製 稿	<div>研發部 2015.03.24 馮斌</div>
產品文件編號:							
陽片數量: 4 張							

INVOTONE

USER'S MANUAL

ACTIVE SPEAKER CABINET **DSX218SA**

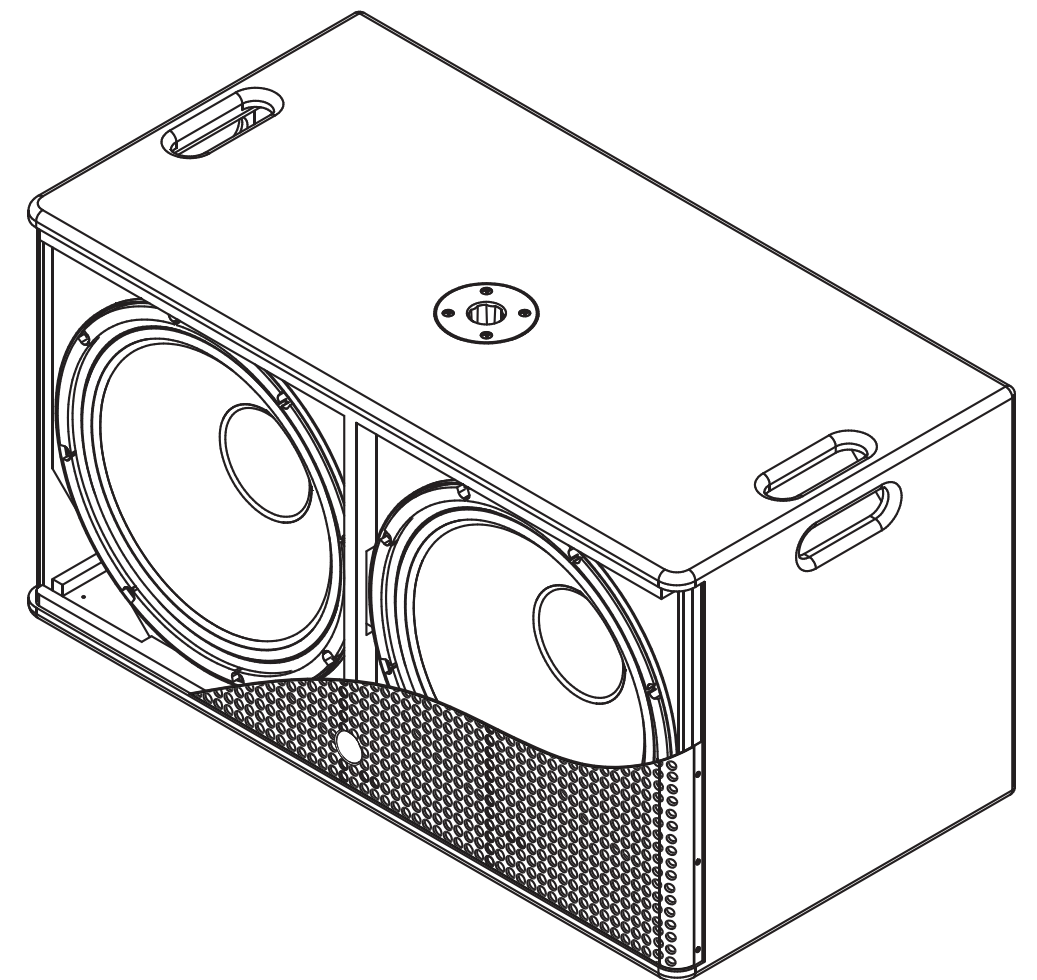

IMPORTANT SAFETY INSTRUCTION





CAUTION
RISK OF ELECTRIC SHOCK
DO NOT OPEN



TO REDUCE THE RISK OF ELECTRIC SHOCK PLEASE DO NOT REMOVE THE COVER OR THE BACK PANEL OF THIS EQUIPMENT. THERE ARE NO PARTS NEEDED BY USER INSIDE THE EQUIPMENT. FOR SERVICE, PLEASE CONTACT QUALIFIED SERVICE CENTERS.

 This symbol, wherever used, alerts you to the presence of un-insulated and dangerous voltages within the product enclosure. These are voltages that may be sufficient to constitute the risk of electric shock or death.

 This symbol, wherever used, alerts you to important operating and maintenance instructions. Please read.

-  Protective Ground Terminal
-  AC mains (Alternating Current)
-  Hazardous Live Terminal

ON: Denotes the product is turned on.

OFF: Denotes the product is turned off.

CAUTION

Describes precautions that should be observed to prevent damage to the product.

- Read this Manual carefully before operation.
- Keep this Manual in a safe place.
- Be aware of all warnings reported with this symbol.



- Keep this Equipment away from water and moisture.
- Clean it only with dry cloth. Do not use solvent or other chemicals.
- Do not damp or cover any cooling opening. Install the equipment only in accordance with the Manufacturer's instructions.
- Power Cords are designed for your safety. Do not remove Ground connections! If the plug does not fit your AC outlet, seek advice from a qualified electrician. Protect the power cord and plug from any physical stress to avoid risk of electric shock. Do not place heavy objects on the power cord. This could cause electric shock or fire.
- Unplug this equipment when unused for long periods of time or during a storm.
- Refer all service to qualified service personnel only. Do not perform any servicing other than those instructions contained within the User's Manual.

- To prevent fire and damage to the product, use only the recommended fuse type as indicated in this manual. Do not short-circuit the fuse holder. Before replacing the fuse, make sure that the product is OFF and disconnected from the AC outlet.

WARNING

To reduce the risk of electric shock and fire, do not expose this equipment to moisture or rain.



Dispose of this product should not be placed in municipal waste and should be separate collection.

- Move this Equipment only with a cart, stand, tripod, or bracket, specified by the manufacturer, or sold with the Equipment. When a cart is used, use caution when moving the cart / equipment combination to avoid possible injury from tip-over.



- Permanent hearing loss may be caused by exposure to \ extremely high noise levels. The US. Government's Occupational Safety and Health Administration (OSHA) has specified the permissible exposure to noise level. These are shown in the following chart:

HOURS X DAY	SPL	EXAMPLE
8	90	Small gig
6	92	train
4	95	Subway train
3	97	High level desktop monitors
2	100	Classic music concert
1,5	102	
1	105	
0,5	110	
0,25 or less	115	Rock concert

According to OSHA, an exposure to high SPL in excess of these limits may result in the loss of heat. To avoid the potential damage of heat, it is recommended that Personnel exposed to equipment capable of generating high SPL use hearing protection while such equipment is under operation.

The apparatus shall be connected to a mains socket outlet with a protective earthing connection.

The mains plug or an appliance coupler is used as the disconnect device, the disconnect device shall remain readily operable.

FREQUENCY RESPONSE DIAGRAMS

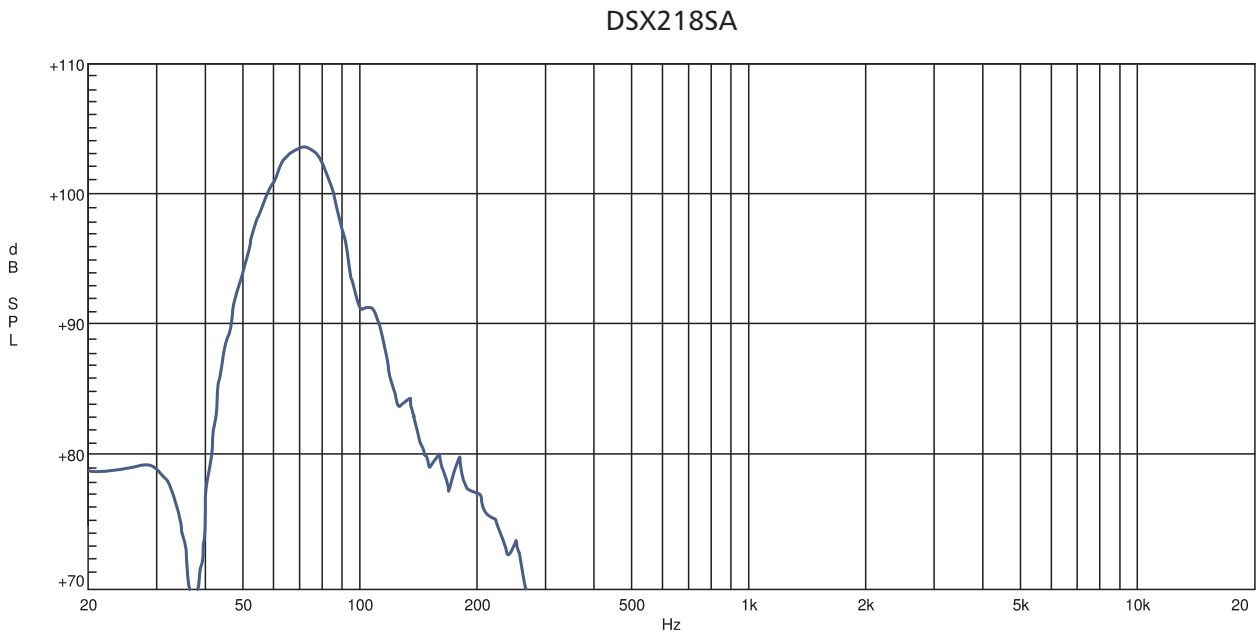

TECHNICAL SPECIFICATIONS

Model Active	DSX218SA
System Type	2*18" Active Subwoofer
Output Power	1000W RMS, 2000W Program
Woofer	2 x 18" Woofer, 3" Voice Coil
Max. SPL	133 dB
Frequency Response (-6dB)	35Hz to 120Hz
Crossover Frequency	Low pass band type 12dB/oct , Analog processor.
Connectors	Input: Left Mono (Combo) / Right (XLR-F) / Output: Left Mono / Right (XLR-M), Link-Left / Mono-Right (XLR-M)
External Controls	Volume Control / Phase Switch / HPF-100Hz for L-R Satellite or By Pass / Power ON with Green LED / Clip Limiter with Red LED / Ground Lift
Electronic Protections	Thermal / Convection-Fan / Overload / Lim./Compressor
Power Supply	Seleccionable 110-120V-50/60Hz / 220-240V-50/60Hz
Enclosure Construction	Plywood cabinet, resistant black paint, metal grille with black foam, rubber feet, two Wood Handles
Mounting	One metal standard pole-mount
Dimensions (HxWxD)	21.06" (535mm) x 20.41" (518mm) x 52.36" (1000mm)
Net weight	46.64Kg / 102.82Lbs.

WIRE CONNECTIONS

Either the 1/4" TRS phone jack or XLR connector can be wired in balanced and unbalanced modes, which will be determined by the actual application status, please wire your system as the following wiring examples:

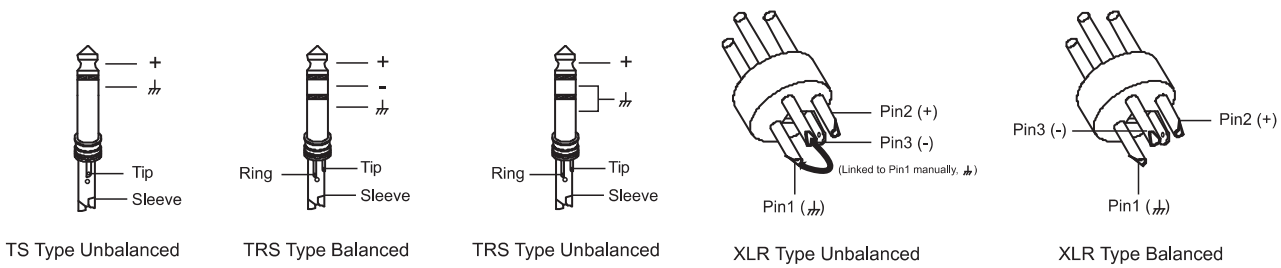

In-line Connection

For these applications the unit provides 1/4" TRS and XLR connectors to easily interface with most professional audio devices. Follow the configuration examples below for your particular connection:

Balanced

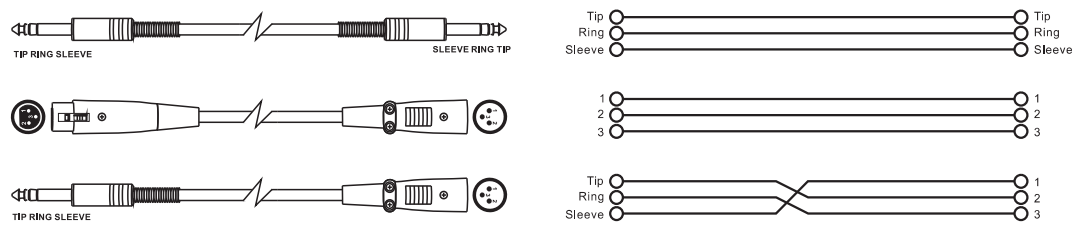

Unbalanced

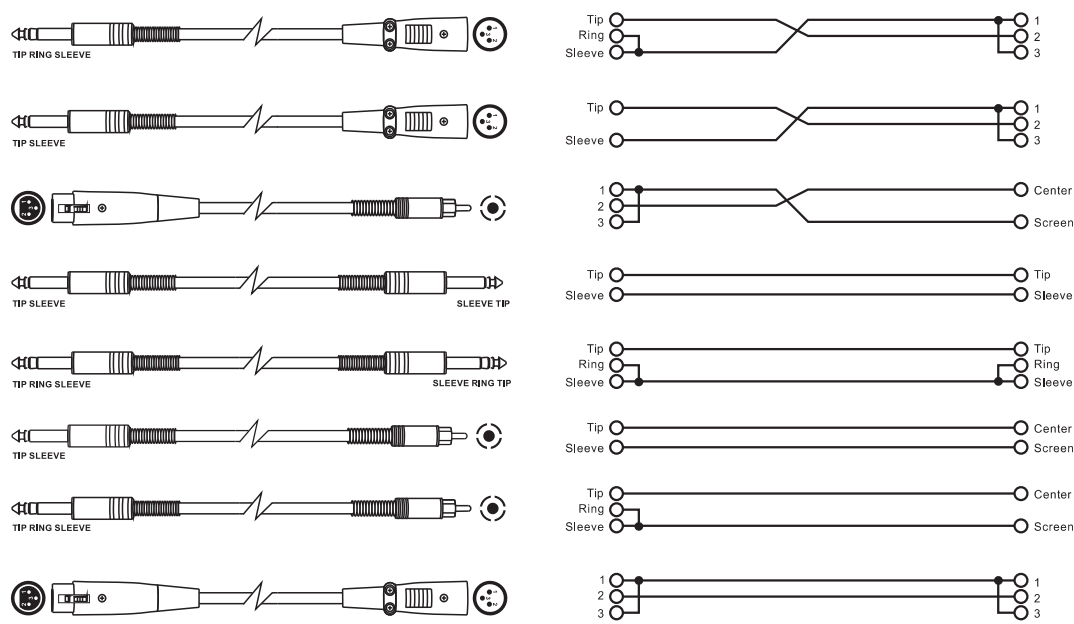

TABLE OF CONTENTS

1. PROLOGUE 2

2. FEATURES 2

3. BACK PANEL DESCRIPTION 3

4. CONNECTION PLATE 4

5. WIRE CONNECTIONS 5

6. FREQUENCY RESPONSE DIAGRAMS 6

7. TECHNICAL SPECIFICATIONS 6

PROLOGUE

Thank you for choosing **INVOTONE**. The **INVOTONE DSX218SA** cabinets have been Designed to provide a cost effective high grade solution while maintaining high quality construction and optimum components.

The **DSX218SA** is designed light weight powered loudspeaker systems and all new class D power amplifiers. This series also breaks from the traditional loudspeaker paradigm, every model is fit with the identical 3" voice coil Compression Driver and woofer of high quality for unparalleled performance, regardless of speaker size. Extensive DSP processing is employed throughout, providing levels of sonic clarity and total output that defy the system's size and weight.

Premium-grade materials, advanced construction processes and multiple mounting and suspension options allow for a wide range of live and installed applications. Great pride & care is placed in delivering products with excellent performance, specifications, and dependable reliability. Every **INVOTONE** audio product is strictly tested and complied to very strict standards.

Please carefully read this manual before starting operation! Thank you again for choosing **DSX218SA**

DSX218SA are Active Subwoofers for professional use, they can be used in following electromagnetic environment: residential, commercial and light industrial, urban outdoors. They are the apparatus Not intended for rack mounting.

FEATURES

- 2000W Class D BI-AMP
- Connectors: Input: Left Mono (Combo) / Right (XLR-F) / Output: Left Mono / Right (XLR-M), Link-Left/ Mono-Right (XLR-M) Balanced 15K ohms.
- Volume control / Power ON with green LED / Clip limiter with Red LED / Ground lift / Switch for Input Sens / Switch On for front Led / IP Control Module (Optional)
- Protections: Thermal/ convection fan / overload /Digital Lim / compressor.
- 110-120V~50/60Hz or 220-240V~50/60Hz switchable.
- Plywood cabinet, resistant black paint, metal grille with foam, rubber feet, double handle.
- One metal standard pole-mount plus

BACK PANEL DESCRIPTION

Active Subwoofer DSX218SA

- (1) On-Off Main power switch
- (2) AC Power socket with main fuse
- (3) Power and activity indicator green LED
- (4) High pass filter or bypass selector
- (5) Ground selector (GND)
- (6) Right line input XLR connector
- (7) Left line mono input Combo connector
- (8) Left-Right Link XLR connector
- (9) Peak and signal presence red LED
- (10) Volume main power control
- (11) Normal/Reverse phase switch (Polarity)
- (12) Left-Right Line Output XLR connector
- (13) Voltage selector

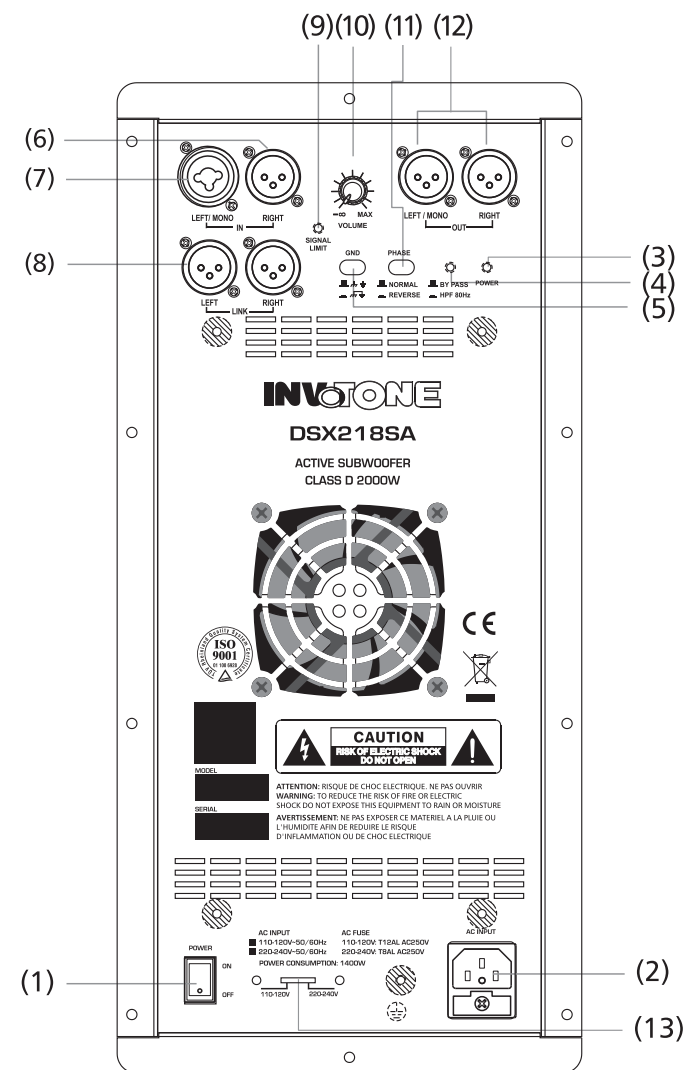

CONNECTION PLATE

